

GAVILAN COLLEGE

GILROY CAMPUS



GC FACILITIES MASTER PLAN UPDATE

APRIL 16, 2020



WELCOME TO GILROY CAMPUS ZOOM MEETING

This meeting will be recorded for note taking purposes

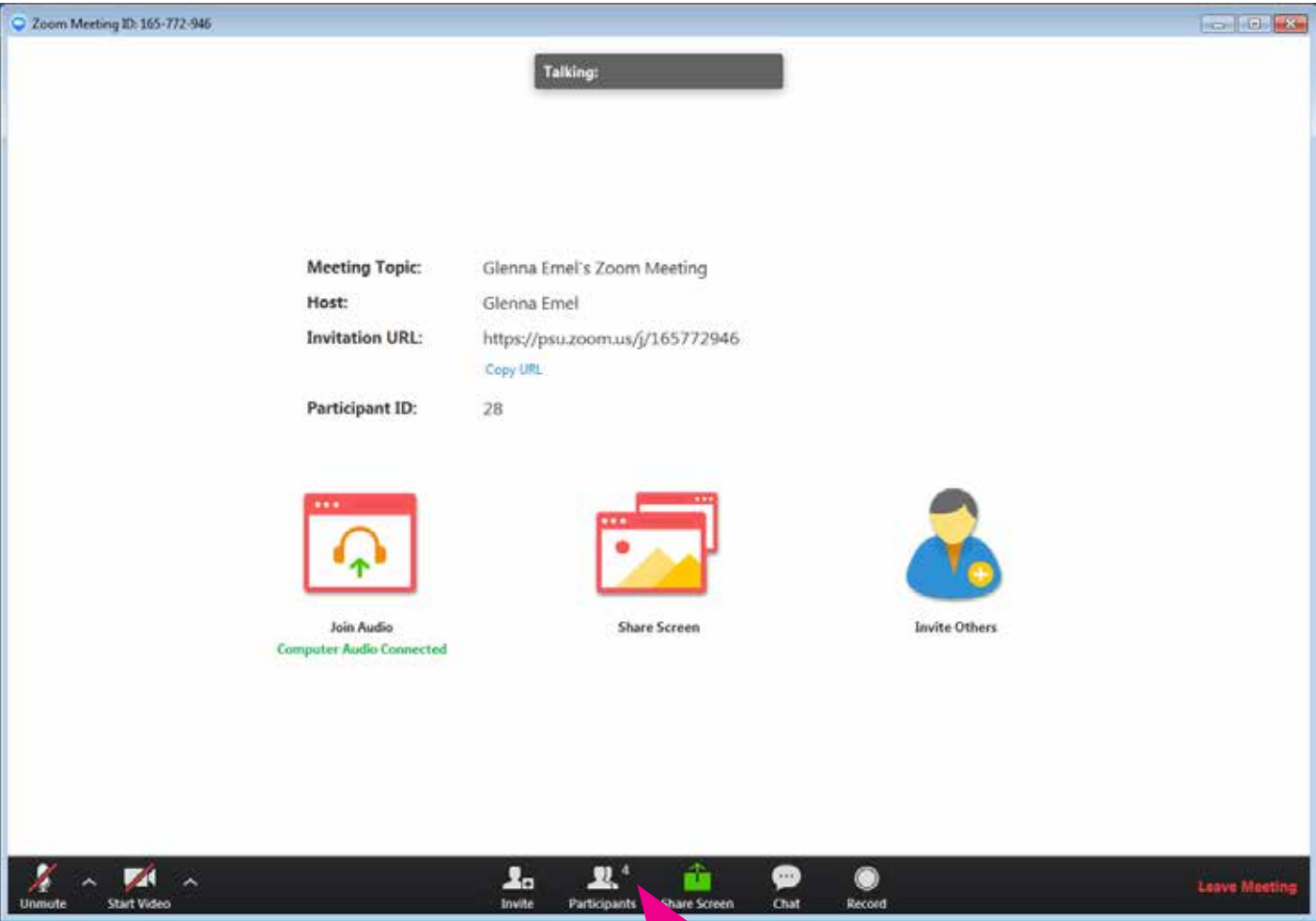

Hover over the bottom of your screen for controls to appear

Click on **Participants** and a window will pop up. You can access non-verbal feedback icons. Place an icon beside your name to quickly notify the host.

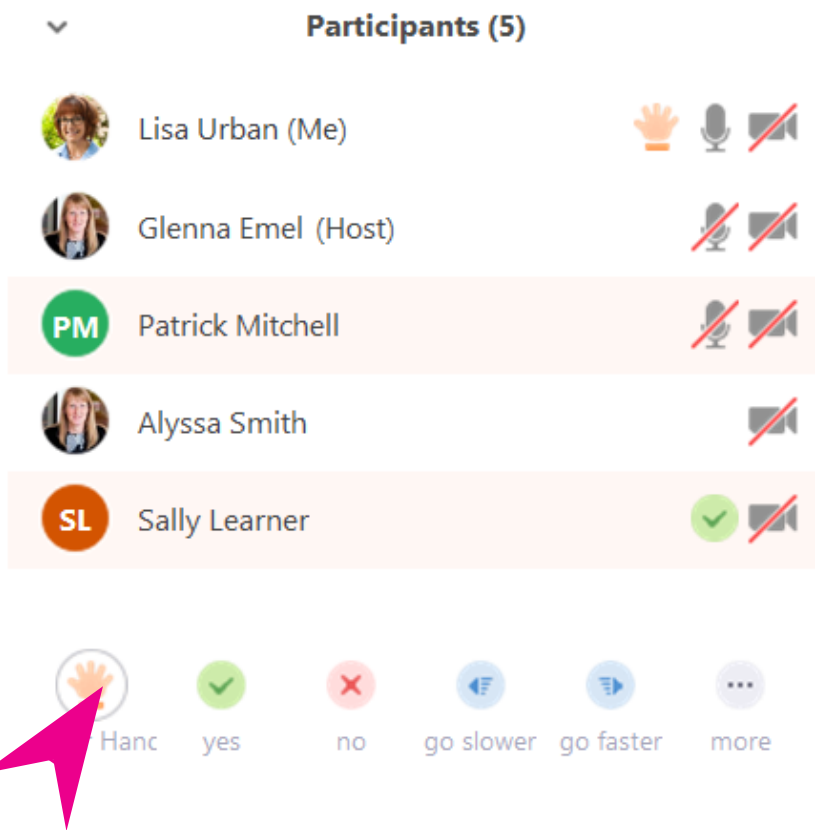

Use **Raise your Hand** icon to notify the host you have a question or would like to make a comment.

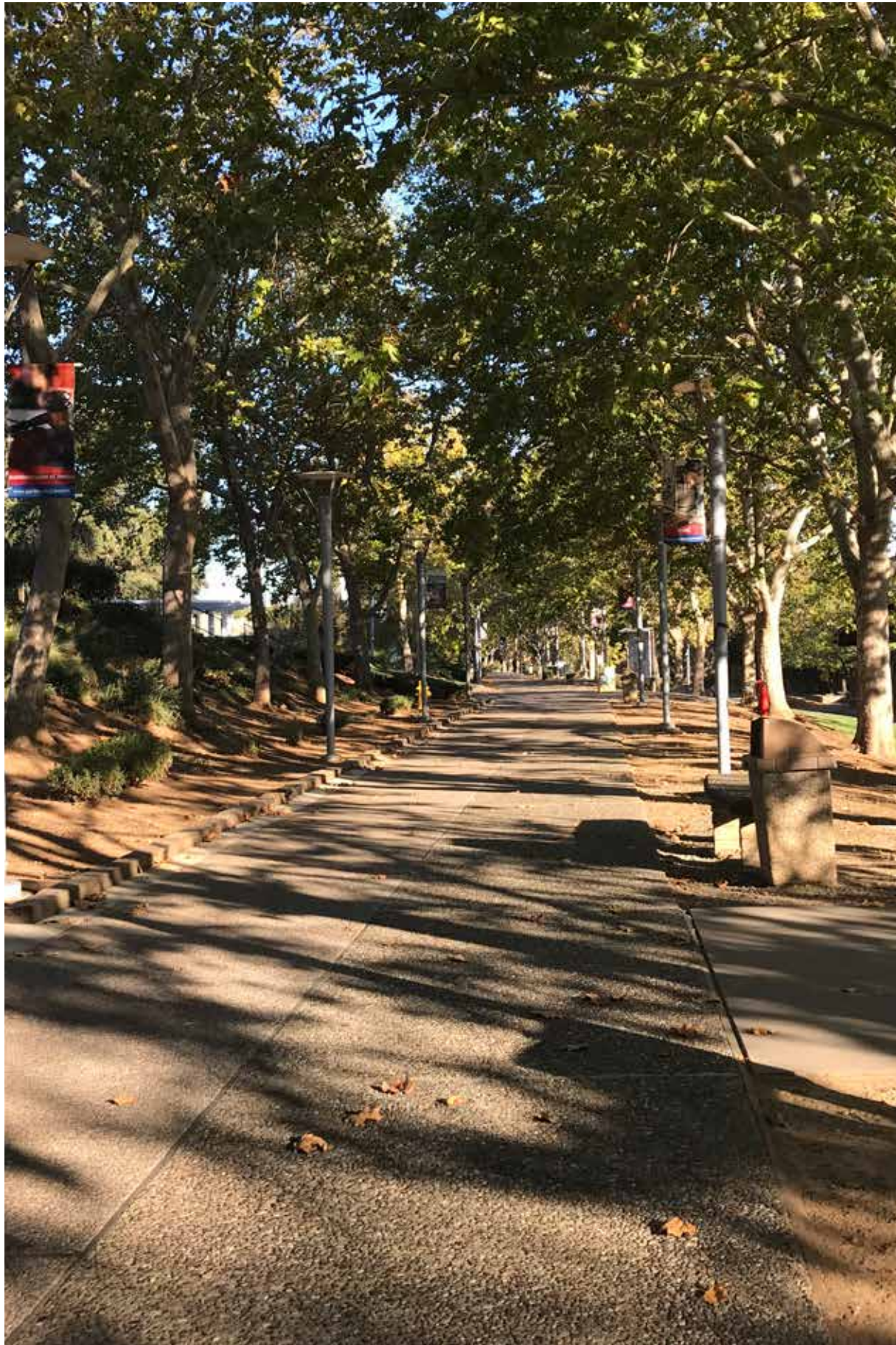

CONTENTS

- 01** Analysis + Findings
- 02** Draft Recommendations
- 03** Landscape Concept

ANALYSIS + FINDINGS

01

ASGC EVENT 11.19.2019

Students were involved in many discussions during the planning process.

The planning team gathered all responses received from students during the Associated Students of Gavilan College (ASGC) event in November 2019.

- Favorite spaces on Campus:
 - / Library
 - / Student Center
 - / Art and Humanities buildings
 - / The pond
 - / The trails
 - / The knoll
- Least Favorite spaces on Campus:
 - / Parking lot C
 - / Gymnasium Location
(due to bridge impact)



ASGC EVENT 11.19.2019

Participants were asked to share their ideas for the future of the campus. The comments were analyzed, sorted and grouped in seven key issues and opportunities.



WAYFINDING

“Clear ADA Pathways”



CAMPUS ART

“Students Murals”



MOVEMENT

“Walking paths”
“Hiking trails”



OPEN SPACE

“Gathering space for students interaction”



PARKING

“More parking in lot C”



ACTIVE LEARNING

“Independent small group spaces”



SECURITY

“Well lit pathways”



Campus Analysis

Existing Circulation

The planning team conducted an assessment on campus-wide related issues and buildings specific conditions.

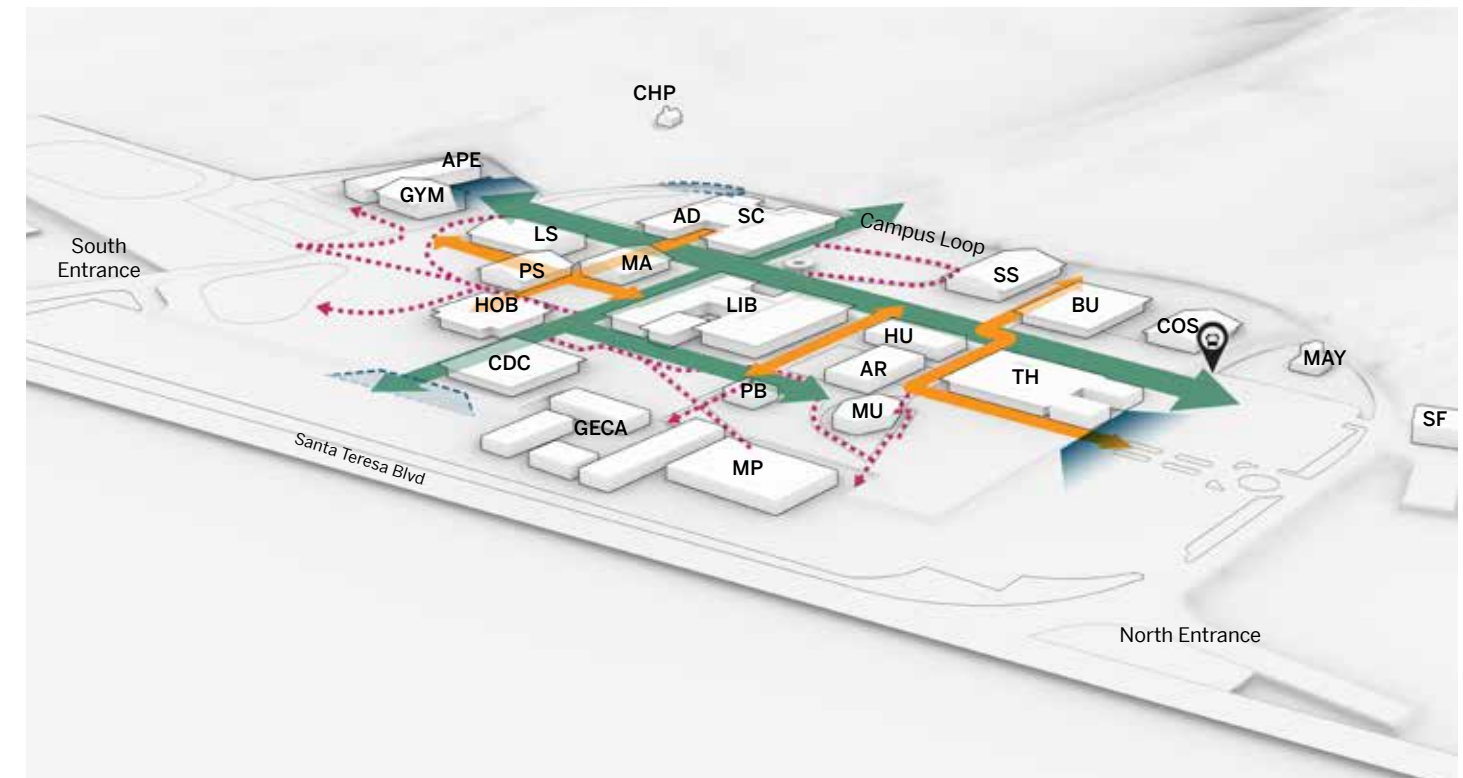
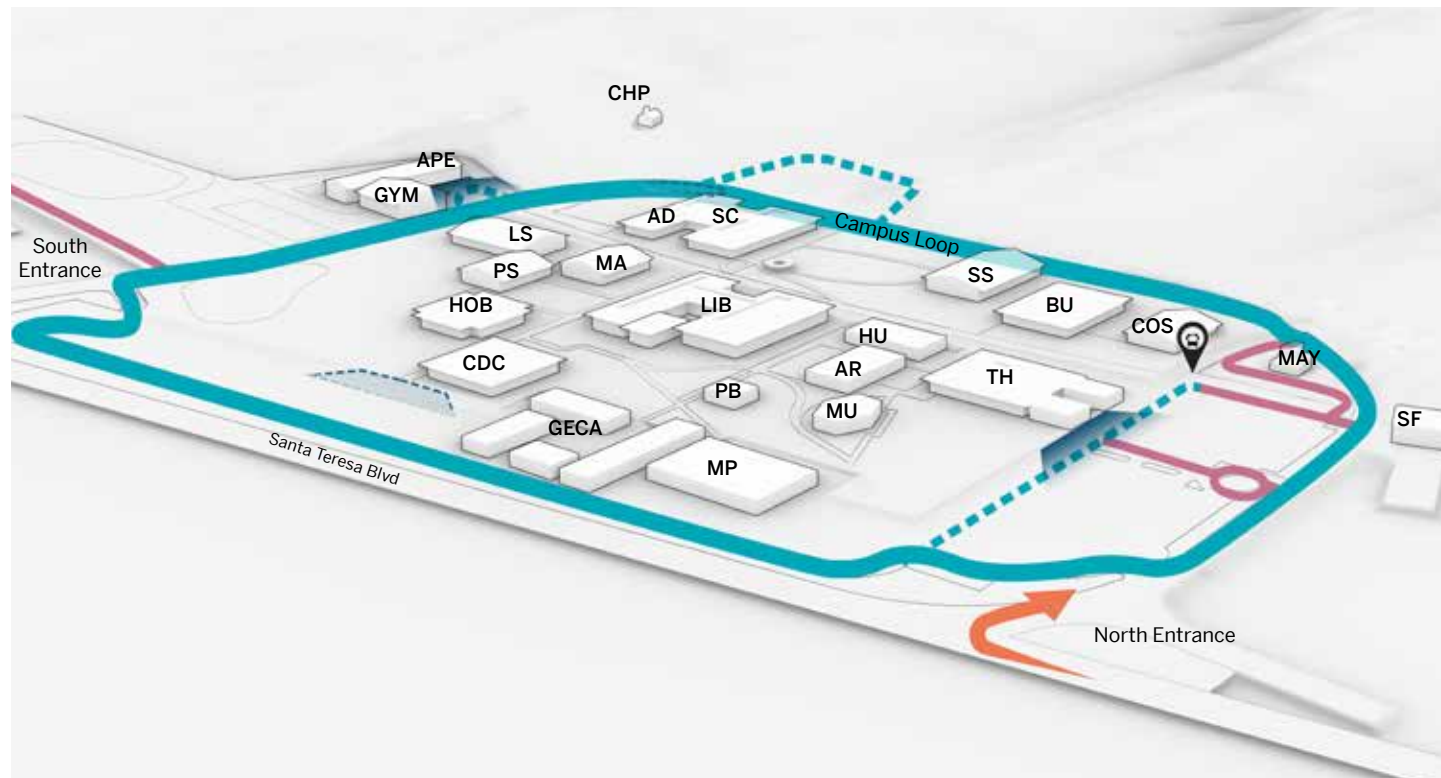

VEHICULAR CIRCULATION

- The majority of vehicles enter from the North Entrance
- Iconic tree marking round-a-bout is not primary entrance to Campus
- Parking lot C is the most used by students and faculty
- Driving through the easternmost road is not a pleasant experience (back of house)

PEDESTRIAN CIRCULATION

- Main pedestrian circulation is on Sycamore Lane
- The athletics zone is not well connected
- Organization is lacking in the hierarchy of spaces
- Condition of spaces creates left-over areas rather than deliberate
- Elevation changes disrupt open space connections
- Lack of signage at key decision points leaves pedestrians lost and confused

Building Analysis

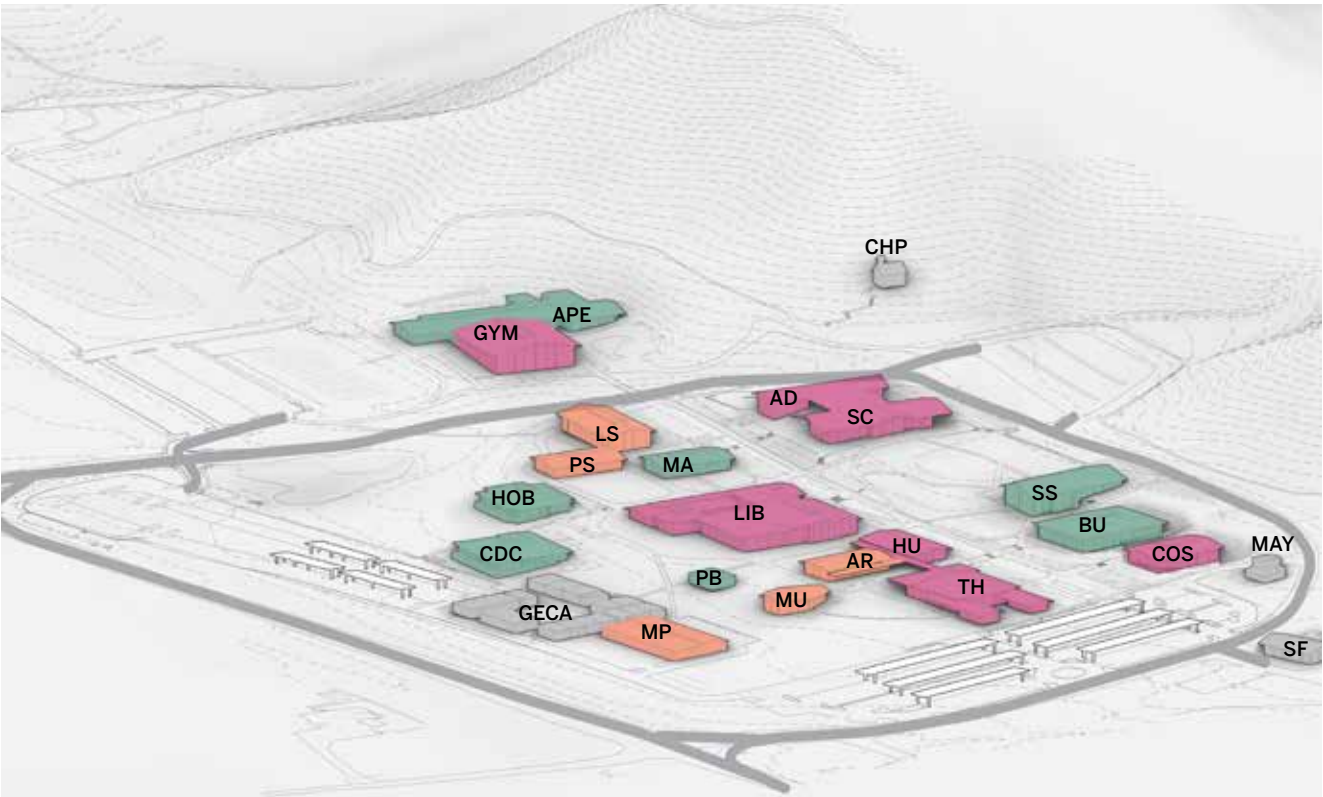

LEGEND

- FCI < 10%
- 10% < FCI < 50%
- FCI > 50%
- N/A

- FCI represents projected repair cost as percentage of replacement cost
- The majority of buildings have an FCI score over 50%, all of which were constructed in the 1960's
- Five buildings have an FCI between 10% and 50%



TABLE 2.2 BUILDING LIFE CYCLE STAGE

MAJOR BUILDING SYSTEMS	FUSION AS- SESSMENT (LIFE LEFT)
A1030 Slab on Grade	86%
B1010 Floor Construction	86%
B1020 Roof Construction	86%
B2020 Exterior Windows	60%
B2010 Exterior Walls	53%
B2030 Exterior Doors	86%
B3010 Roof Coverings	53%
B3020 Roof Openings	30%
C1010 Partitions	53%
C1020 Interior Doors	53%
C3030 Ceiling Finishes	44%
C3010 Wall Finishes	07%
C3020 Floor Finishes	30%
D2010 Plumbing Fixtures	60%
D3020 Heat Generating Systems	60%
D3030 Cooling Generating Systems	53%
D4030 Fire Protection Specialties	60%
D5010 Electrical Service/Distribution	60%
D5030 Communications and Security	30%
F1030 Special Construction Systems	44%

- HEALTH OCCUPATIONS
- STUDENT CENTER / ADMINISTRATION
- LIBRARY
- THEATER
- COMMUNITY DEVELOPMENT & CAREERS

DRAFT RECOMMENDATIONS

02

Planning Principles

The principles described provide the framework for the recommendations for the Campus. They were developed early in the planning process and were used as a guide for the development and evaluation of early concepts and ideas.



PROGRAMMATIC NEEDS

- Replace inefficient and underperforming facilities
- Integrate instructional and student support services
- Position GC to maximize funding (state and local)



COMMUNITY PRESENCE

- Increase visibility
- Strengthen connections with surrounding communities
- Improve community access to College events and performances



ACCESS + WAYFINDING

- Develop welcoming + inviting campus entries
- Develop and clarify circulation patterns
- Enhance wayfinding and campus organization



CONNECTIONS

- Organize campus functions to support the guided pathway model
- Develop new east/west connections, while strengthening existing primary pedestrian routes

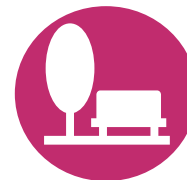

SENSE OF PLACE

- Create a sense of belonging and pride
- Create a collegiate campus identity



HEART OF CAMPUS

- Develop indoor and outdoor spaces to support collaboration
- Reinvigorate the campus nucleus



Recommended Demolition

The Master Plan recommends demolition and replacement of older and outdated buildings on campus. Functions currently housed in these facilities will be relocated to permanent facilities to address program needs.

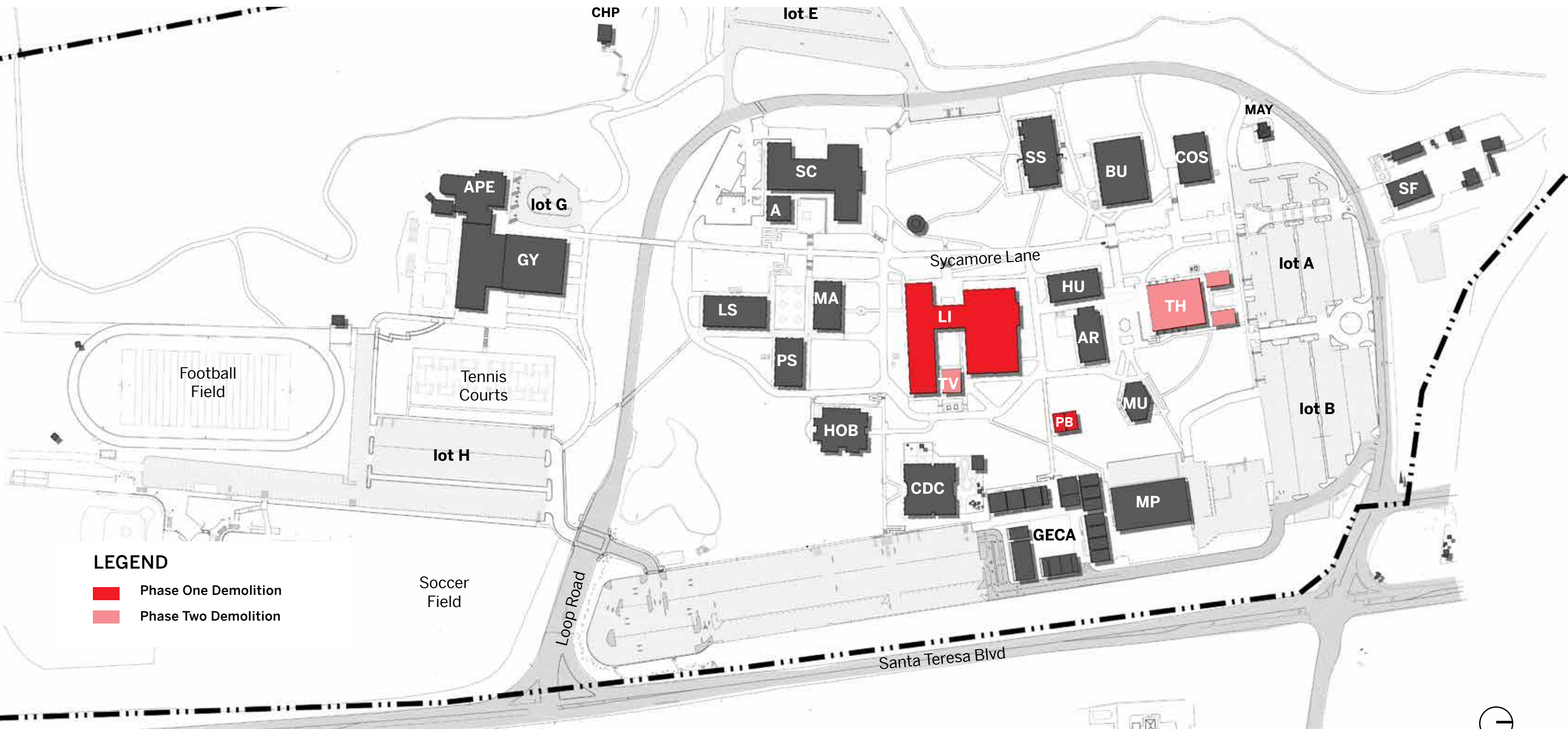



LEGEND

- Phase One Demolition
- Phase Two Demolition

Facilities Master Plan

- Three new buildings are recommended.
 - / Library Student Services
 - / STEM
 - / Performing Art Center
- Renovate three existing buildings, based on their condition (structural and mechanical systems)
 - / Administration
 - / Music
 - / Multipurpose Building
- Landscape improvement and site infrastructure projects are recommended throughout Campus

LEGEND

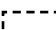
-  Existing Building
-  Proposed New Building
-  Proposed Change of Use
-  Proposed Future Building Site

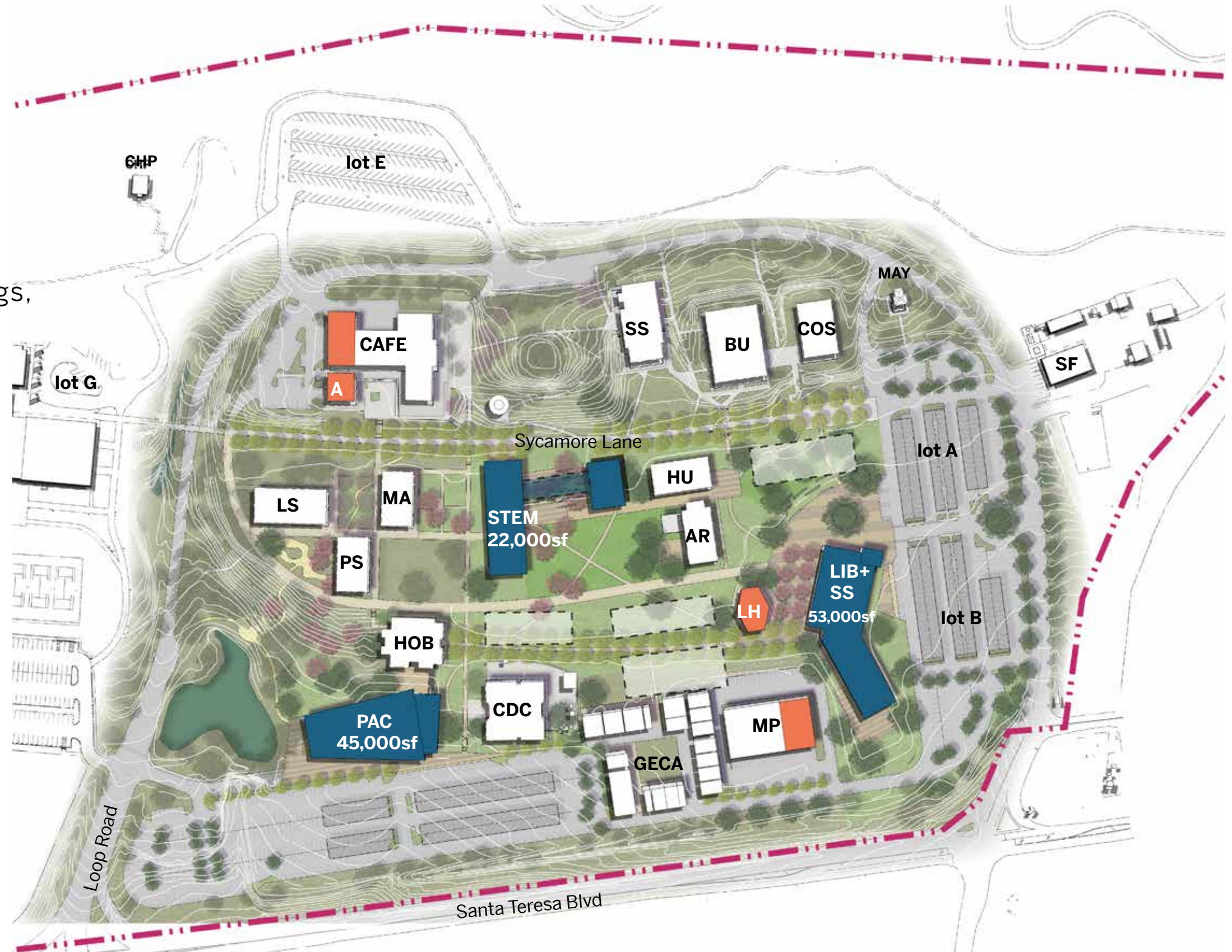

LANDSCAPE CONCEPT

03

Landscape Master Plan

The landscape strategy for GC consists of further clarifying and connecting the topographic organization of campus academic and administrative building clusters and districts.



CAMPUS CORE



COURTYARDS + GARDENS



SLOPED SEATING AREA



LARGE ENTRY PLAZA



EAST-WEST PATHS

Wayfinding + Signage

A series of projects are recommended to enhance the identity of GC within the surrounding community. The graphic shows general location for large scale monuments as well as directional signs.



● DIRECTORIES



● DIRECTIONAL

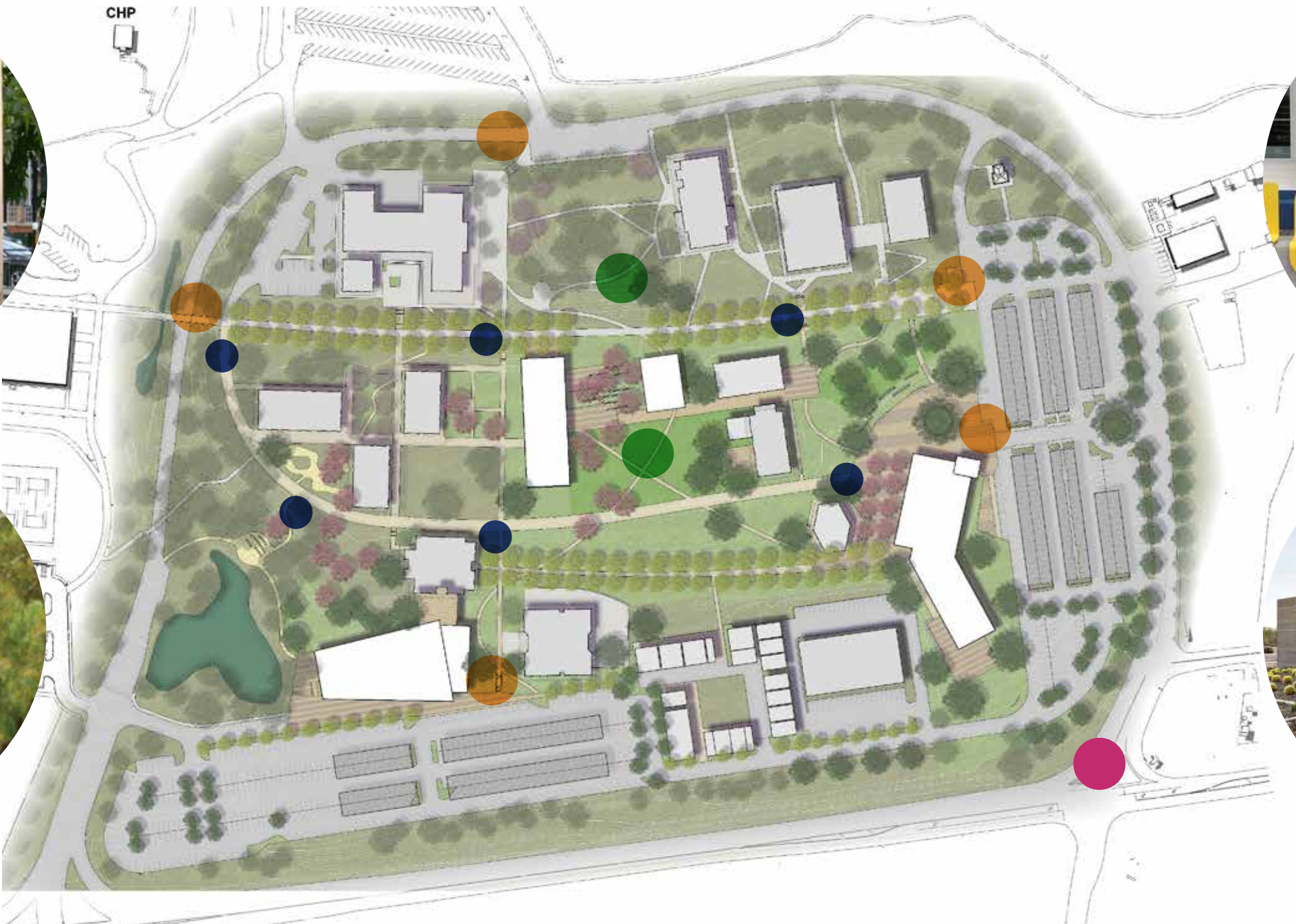

● PLACEMAKING



● MONUMENT SIGN

Facilities Master Plan

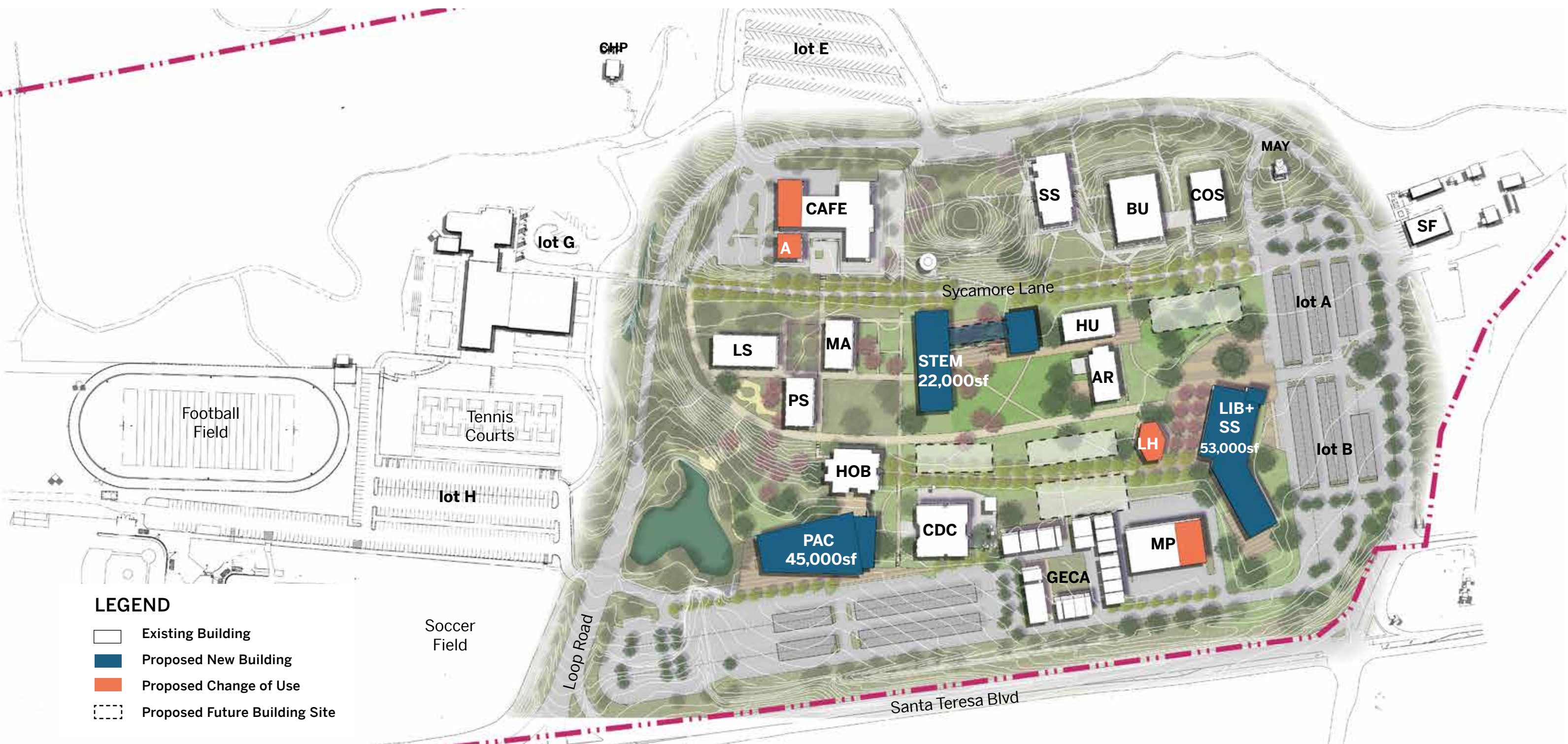

An architectural site plan for the Gilroy Campus Facilities Master Plan. The plan shows a central campus area with various buildings, some highlighted in blue and orange. To the left is a large oval-shaped parking lot and a baseball field. To the right are several rectangular parking lots. A red dashed line runs along the bottom and right edges of the campus. A small building labeled 'CHP' is located at the top left. The word 'QUESTIONS?' is centered over the plan in a large, bold, black font.

QUESTIONS?