

# **GAVILAN COLLEGE / SBCC CENTER**

CLIENT MEETING 6

05.14.2021

## CLIENT MEETING 6 | 05.14.2021

---

1. SCHEDULE
2. MEETING GOALS
3. GUIDING PRINCIPLES
4. DESIGN UPDATE
  - A. SITE
  - B. INTERIOR & EXTERIOR EXPERIENCE
  - C. MATERIALITY
5. DISCUSSION / Q&A

# INTRO | SCHEDULE & MEETING GOALS

Start Date	Feb 1	Week 13	Week 14	Week 15	Week 16	Week 17	Week 18	Week 19	Week 20	Week 21	Week 22	Week 23
		04/26-04/30	05/03-05/07	05/10-05/14	05/17-05/21	05/24-05/28	05/31-06/04	06/07-06/11	06/14-06/18	06/21-06/25	06/28-07/02	07/05-07/09
<b>MEETINGS ROLLUP</b>												
Steering Committee				●			●			●		
Focused Program Meetings												
Facilities / IT / M&O												
Community		4/28	5/3/2021									
San Benito County Campus Task Force												
Bond Executive Team		4/27/2021										
San Benito Ad Hoc Committee		4/29/2021										
Board of Trustees		4/29		5/11/2021								
<b>DESIGN DEVELOPMENT</b>												
		1	2	3	4	5	6	7	8	9	10	11
25% Design Development												
Refined Floor Plan / Test Fits / Interior				●								
Hub				●								
Academic Wing				●								
STEM Wing				●								
Exterior Development				●								
Roof Form and Materials				●								
Openings				●								
Façade				●								
50% Design Development												
Site							●					
Architecture / Interiors							●					
Systems							●					
75% Design Development												
Site										●		
Architecture / Interiors										●		
Systems										●		
100% Design Development												

**TODAY'S MEETING GOALS**

- DETAILED PROGRAM DISCUSSION & BUYOFF
- BUYOFF ON "SHAPE" OF THE BUILDING
- INTRO & DISCUSSION ON EXTERIOR MATERIALS & COLOR ("THE VIBE")

DISTRICT DESIGN GUIDELINES

**FOUNDATIONAL DESIGN OBJECTIVES:**

- SUSTAINABILITY
- EQUITY
- CAMPUS IDENTITY
- MAINTENANCE & SECURITY

PROJECT GUIDING PRINCIPLES:

**THE SBCC CAMPUS WILL:**

- WELCOME THE COMMUNITY
- CREATE AN EXCEPTIONAL AND COLLEGIATE STUDENT EXPERIENCE
- FACILITATE STUDENT CONNECTIONS TO SERVICES AND SUPPORT
- PROVIDE HIGHLY FUNCTIONAL, FLEXIBLE SPACES THAT ENCOURAGE LEARNING AND COLLABORATION
- PROMOTE WELLNESS AND SAFETY
- CONNECT AND INTERACT WITH THE LANDSCAPE
- BE DURABLE AND EASY TO MAINTAIN

# SITE DESIGN

# SITE DESIGN | SITE PLAN

## LEGEND

- 1 PUBLIC BUS STOP.
- 2 MAIN ENTRY ONTO COLLEGE WAY.
- 3 PROMENADE: TREE ALLEE, POLE LIGHTS, TAN COLORED CONC PAVING W/ SAND FINISH, BENCHES.
- 4 SIGN FOR GAVILAN COMMUNITY COLLEGE, SAN BENITO CAMPUS.
- 5 ONE WAY ENTRY AT COLLEGE WAY (SHUTTLE DROP OFF/ PICKUP & STUDENT DROP OFF PICKUP)
- 6 ORCHARD PARKING: AC PAVING, 6 ADA, 7 EV, 5 FUTURE EV. PARKING SPACES TO HAVE 50% SHADE PER CALGREEN. FINAL PARKING MARKING TBD W/ GAVILAN CC.
- 7 NATIVE OAK GROVES: MIXED SIZES AND OAK WOODLAND PLANT COMMUNITY, LOCAL BASALT BENCHES SET UNDER TREES.
- 7A TERRACE OAK GROVES WITH LARGER SPECIMEN TREES.
- 8 SHORT TERM & LONG TERM BIKE PARKING: 8 SHORT TERM BIKE RACKS AND 8 LONG TERM BIKE STORAGE LOCKERS PER CAL GREEN.
- 9 20' WIDE EMERGENCY VEHICLE ACCESS ROUTE ON PAVING OR STABILIZED DECOMPOSED GRANITE OVER AGGREGATE BASE.
- 10 ENTRY PLAZA WELCOMES VISITORS WITH GARDENS, BASALT COLUMNS, AND COLORFUL SHADE TREES. PAVED WITH STEPSTONE 24"X12" PAVERS (3 MIXED TAN COLORS: ADOBE/KONA BROWN/ CAFE BROWN) ALTERNATE: DARK BROWN CONCRETE W/ CARBIDE SILICA SAND FINISH.
- 11 SOUTH AMPHITHEATER (PAVERS OR ALT CONCRETE) PAVING TO MATCH FRONT ENTRY PLAZA AND BUILDING LOBBY. SEE NO. 10 ABOVE. UPPER TERRACE IS SHADED BY ROOF OVERHANG AND TREES. CONCRETE TERRACES HAVE RECYCLED WOOD SEATING, INTEGRATED PLANTING, AND ADA SEATING. STEPS AND RAMP TO LOWER STAGE LEVEL IN FRONT OF DISPLAY WALL ARE SHADED BY OAK GROVE SOUTH OF STAGE. ACCESSIBLE SYNTHETIC TURF IS AT THE BOTTOM OF AMPHITHEATER.
- 12 OUTDOOR LEARNING TERRACES: COLORED CONCRETE PAVING. STABILIZED DECOMPOSED GRANITE ON NORTHEAST OUTDOOR LEARNING TERRACE.
- 13 PERIMETER EDUCATIONAL GARDENS FOR MEDITATION AND NATIVE HABITAT / POLLINATORS.
- 14 NATIVE CALIFORNIA FLOWERING MEADOW. NATIVE WILDFLOWERS AND LOW GRASSES. SMALL GROUPINGS OF ADIRONDACK READING CHAIRS SCATTERED IN MEADOWS.
- 15 RIPARIAN GROVES: PLANTING OF NATIVE CALIFORNIA SYCAMORES AND NATURAL RIPARIAN UNDERSTORY.
- 16 NATURE DISCOVERY TRAIL WITH REST STOPS AND NATIVE PLANTING WITH SEATING UNDER TREE SHADE, .3 MILE & .5 MILE LOOPS.
- 17 FUTURE GROUND-MOUNTED SOLAR ARRAY FOR ZERO NET POWER.
- 18 EXISTING PASTURE.
- 19 TRASH AND WASH DOWN ENCLOSURE: ROOFED WITH SEWER AND WATER CONNECTION. EMERGENCY GENERATOR. (2) 6-YARD DUMPSTERS, FRONT LOADED, AND 1-3 YARD RECYCLING BIN.
- 20 MAIN ELECTRICAL POWER TRANSFORMER, SWITCH GEAR AND PHOTOVOLTAIC SYSTEM IN 8 FOOT TALL, FENCED ENCLOSURE, SCREENED WITH LANDSCAPE IN PARKING LOT.
- 21 PG&E EASEMENT & ELECTRICAL UNDERGROUNDING.
- 22 SEASONAL DRAINAGE SWALE / NATURAL LOW POINT.



INTERSECTION - BEFORE



INTERSECTION - **AFTER**





# INTERIOR & EXTERIOR EXPERIENCE

- COMMUNITY
- STUDENT SERVICES / OFFICE
- SCIENCE
- GENERAL LECTURE
- SITE & NATURE

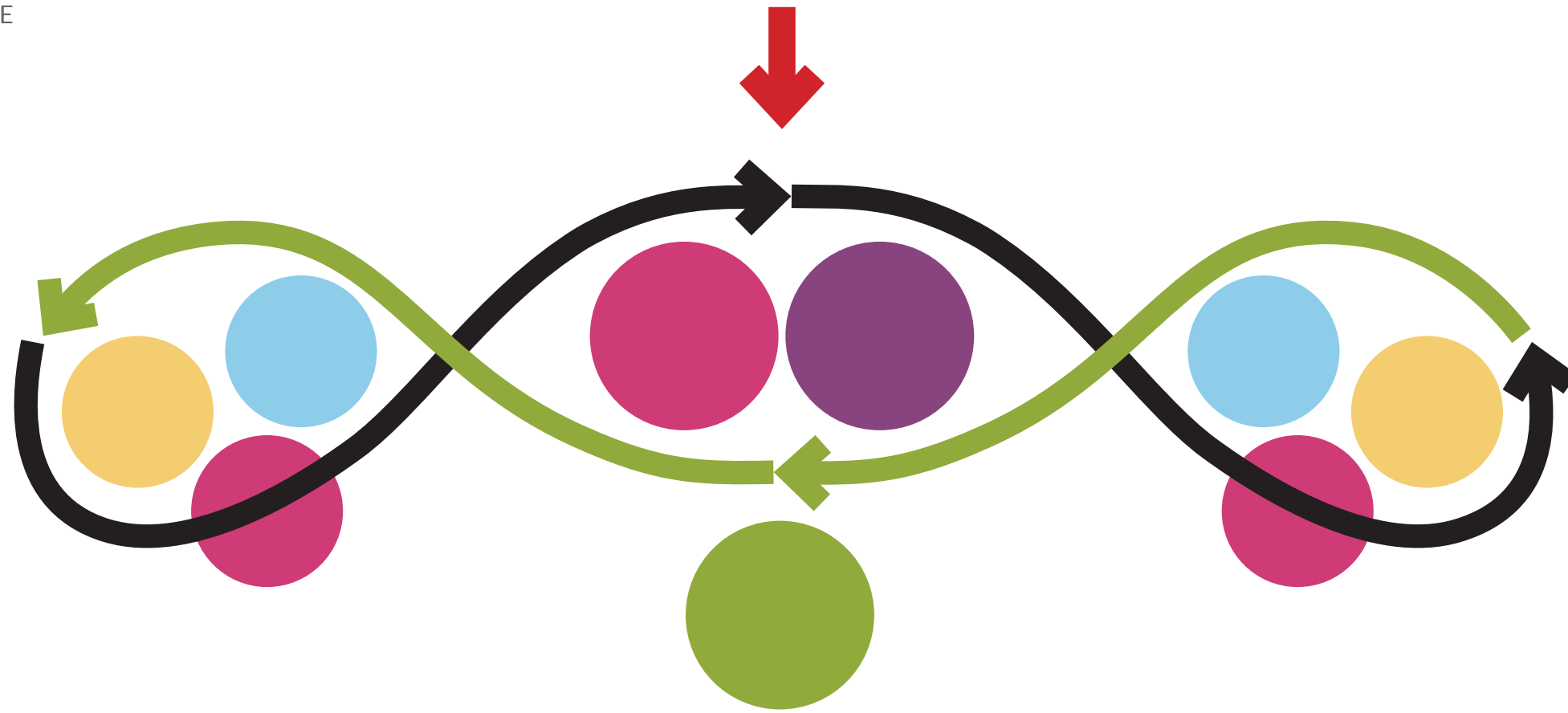

A **GUIDED PATH** THAT FACILITATES **OPEN CHOICE AND DISCOVERY**

# PROGRAM LAYOUT

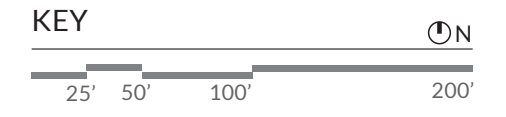

- SCIENCE
- GEN. ED.
- FACULTY OFFICES
- STUDENT SERVICES & SBCC
- COLLABORATIVE, CAFE & RECEPTION
- LRC & COMMUNITY
- COMPUTER LABS
- BACK-OF-HOUSE

# PROGRAM LAYOUT

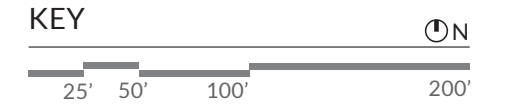

- SCIENCE
- GEN. ED.
- FACULTY OFFICES & SBCC
- STUDENT SERVICES
- COLLABORATIVE, CAFE & RECEPTION
- LRC & COMMUNITY
- COMPUTER LABS
- BACK-OF-HOUSE

# PROGRAM LAYOUT - CENTRAL HUB



- KEY** N
- SCIENCE
  - GEN. ED.
  - FACULTY OFFICES & SBCC
  - STUDENT SERVICES
  - COLLABORATIVE, CAFE & RECEPTION
  - LRC & COMMUNITY
  - COMPUTER LABS
  - BACK-OF-HOUSE

AREA ENLARGED

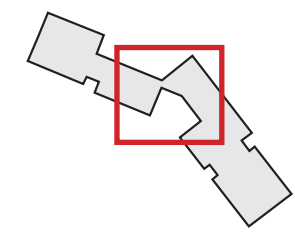

# PROGRAM LAYOUT - COMMUNITY ROOM: ALT LAYOUT



- KEY** N
- SCIENCE
  - GEN. ED.
  - FACULTY OFFICES & SBCC
  - STUDENT SERVICES
  - COLLABORATIVE, CAFE & RECEPTION
  - LRC & COMMUNITY
  - COMPUTER LABS
  - BACK-OF-HOUSE

AREA ENLARGED

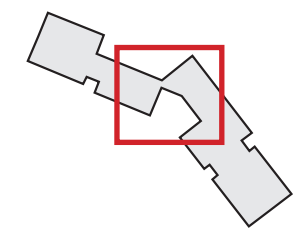

# PROGRAM LAYOUT - LRC & SBCC



**KEY** N

- SCIENCE
- GEN. ED.
- FACULTY OFFICES & SBCC
- STUDENT SERVICES
- COLLABORATIVE, CAFE & RECEPTION
- LRC & COMMUNITY
- COMPUTER LABS
- BACK-OF-HOUSE

AREA ENLARGED

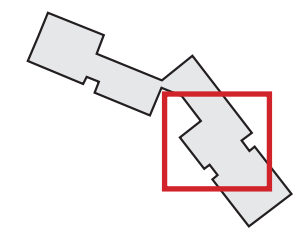

# PROGRAM LAYOUT - SCIENCE WING



**KEY** N

- SCIENCE
- GEN. ED.
- FACULTY OFFICES & SBCC
- STUDENT SERVICES
- COLLABORATIVE, CAFE & RECEPTION
- LRC & COMMUNITY
- COMPUTER LABS
- BACK-OF-HOUSE

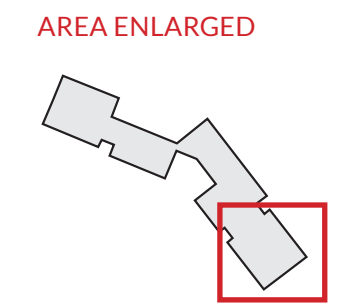



# PROGRAM LAYOUT - ACADEMIC WING



**KEY** N

- SCIENCE
- GEN. ED.
- FACULTY OFFICES & SBCC
- STUDENT SERVICES
- COLLABORATIVE, CAFE & RECEPTION
- LRC & COMMUNITY
- COMPUTER LABS
- BACK-OF-HOUSE

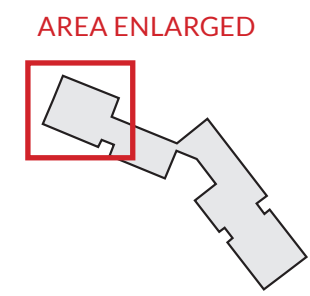

INTERIOR & EXTERIOR EXPERIENCE | **MASSING OVERVIEW: NORTH**



BUILDING ENTRY

ENTRY PLAZA

PARKING AREA

ACADEMIC WING

DROPOFF ZONE

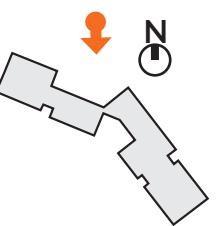

INTERIOR & EXTERIOR EXPERIENCE | **MASSING OVERVIEW: SOUTH**



COMMUNITY ROOM

SOUTH TERRACE

LEARNING RESROUCE CENTER

ACADEMIC WING

OUTDOOR CLASSROOM

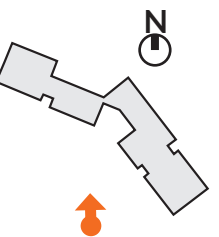

INTERIOR & EXTERIOR EXPERIENCE | **ENTRY PLAZA**



PLANTER BENCHES

BUILDING ENTRY

ENTRY PLAZA

ENTRY GARDEN

MURAL WALL

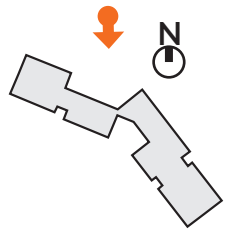

INTERIOR & EXTERIOR EXPERIENCE | **CENTRAL HUB**



TO ACADEMIC WING

COMMUNITY TABLE & RECEPTION AREA

OUTDOOR TEACHING & PERFORMANCE AREA

SOUTH TERRACE

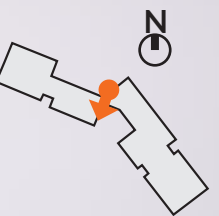

INTERIOR & EXTERIOR EXPERIENCE | **CENTRAL HUB**



COMMUNITY TABLE  
& RECEPTION AREA

OCULUS

CAFE & PANTRY

SOUTH  
TERRACE

INTERIOR & EXTERIOR EXPERIENCE | **SOUTH TERRACE**



COMMUNITY ROOM

SOUTH TERRACE

TEACHING & PERFORMANCE AREA

LEARNING RESOURCES CENTER



INTERIOR & EXTERIOR EXPERIENCE | **MEADOW**



ACADEMIC WING

COMMUNITY ROOM

SOUTH TERRACE

NATIVE FLOWER MEADOWS

LEARNING RESOURCES CENTER



INTERIOR & EXTERIOR EXPERIENCE | **SOUTH FACADE**



OUTDOOR CLASSROOM

ACADEMIC WING

COMMUNITY ROOM

SOUTH  
TERRACE

LEARNING  
RESOURCES CENTER

SCIENCE WING

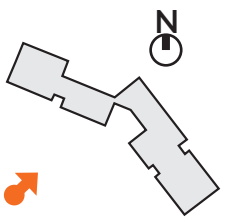

# INTERIOR & EXTERIOR EXPERIENCE | BUILDING SECTION

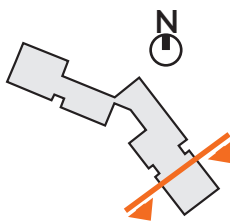
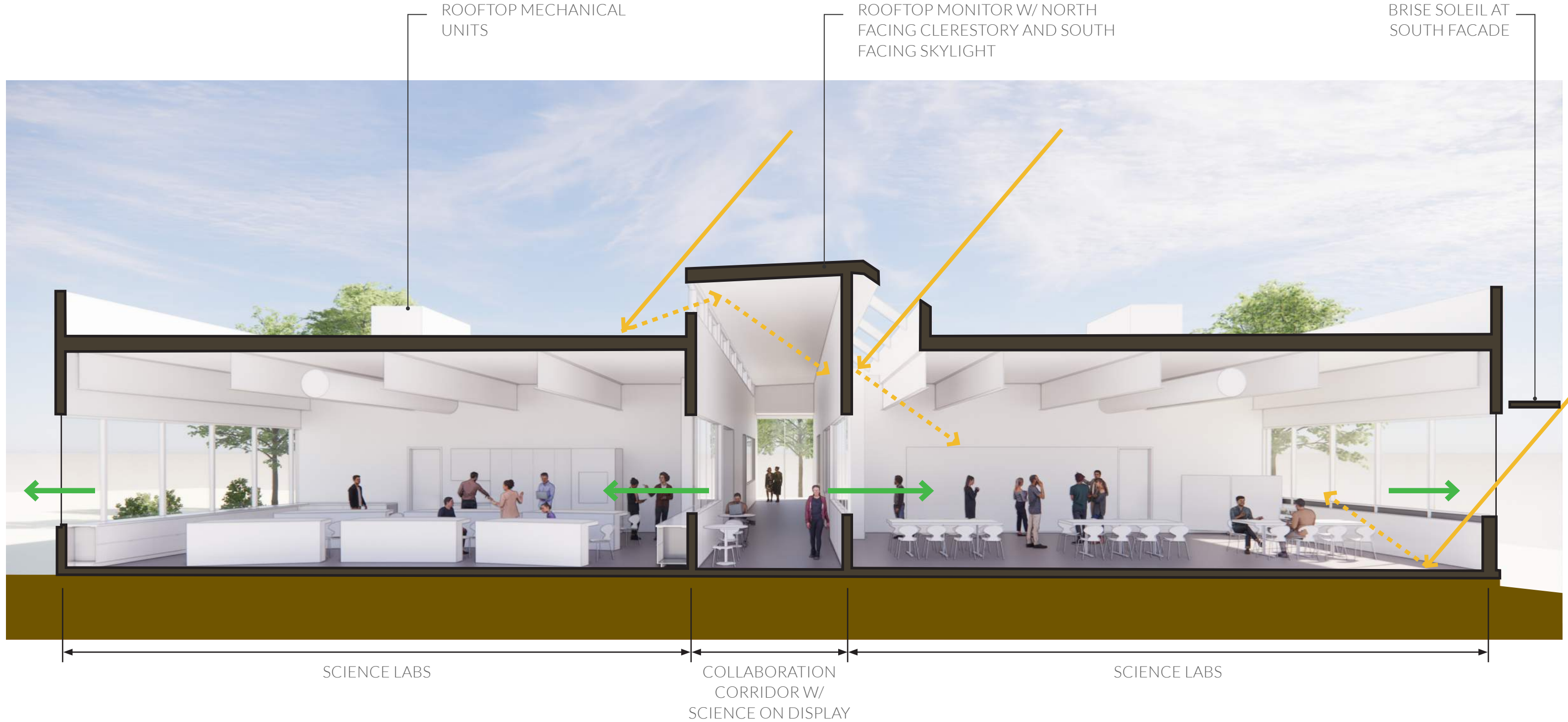

# INTERIOR & EXTERIOR EXPERIENCE | BUILDING SECTION

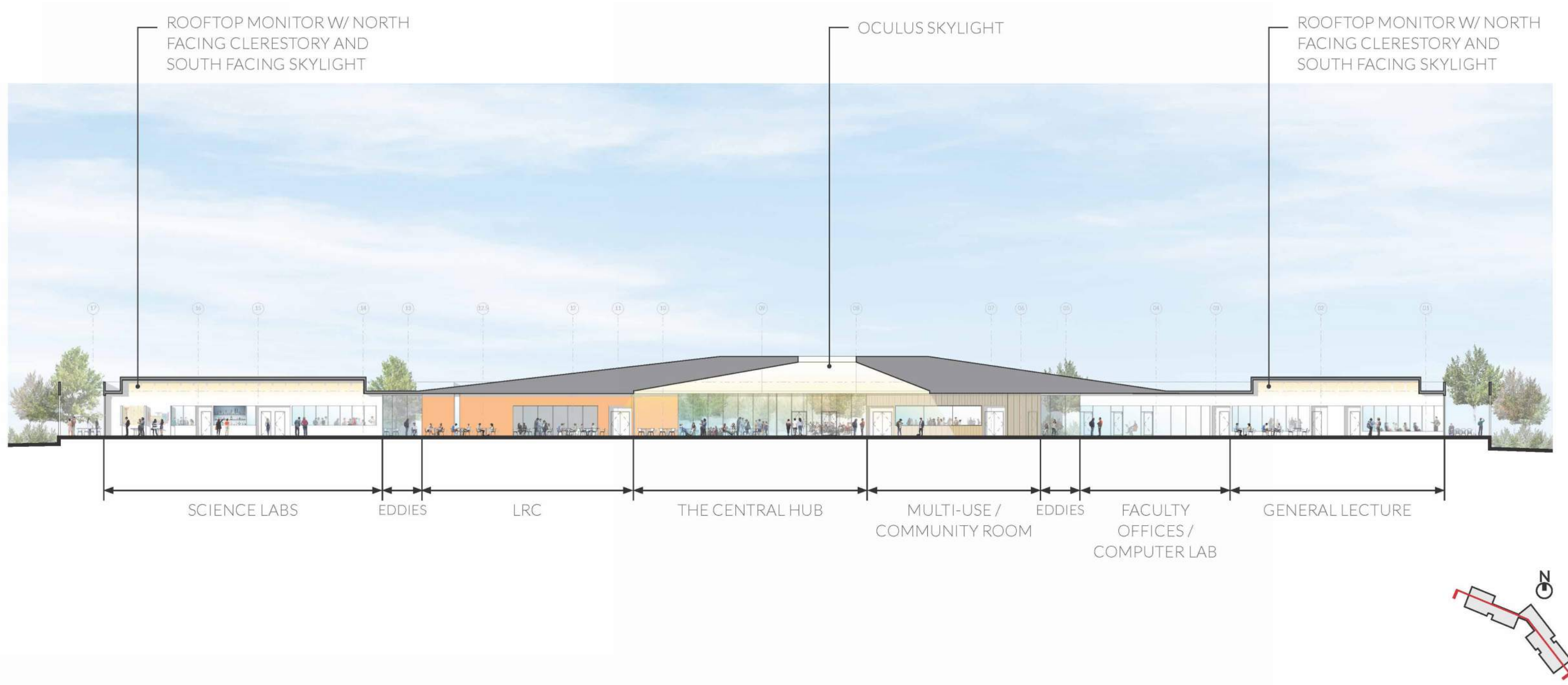

# INTERIOR & EXTERIOR EXPERIENCE | BUILDING MATERIALITY

